

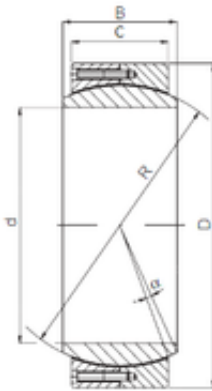

IFB Roller Industry Co.,Ltd

ISO GE530DW plain bearings



Bearing No. GE530DW

Size	530x710x243 mm
Bore Diameter	530 mm
Outer Diameter	710 mm
Width	243 mm
d	530 mm
D	710 mm
B	243 mm
C	205 mm
R	620 mm
Angle	3,7 °

GE530DW Bearing 2D drawings and 3D CAD models